

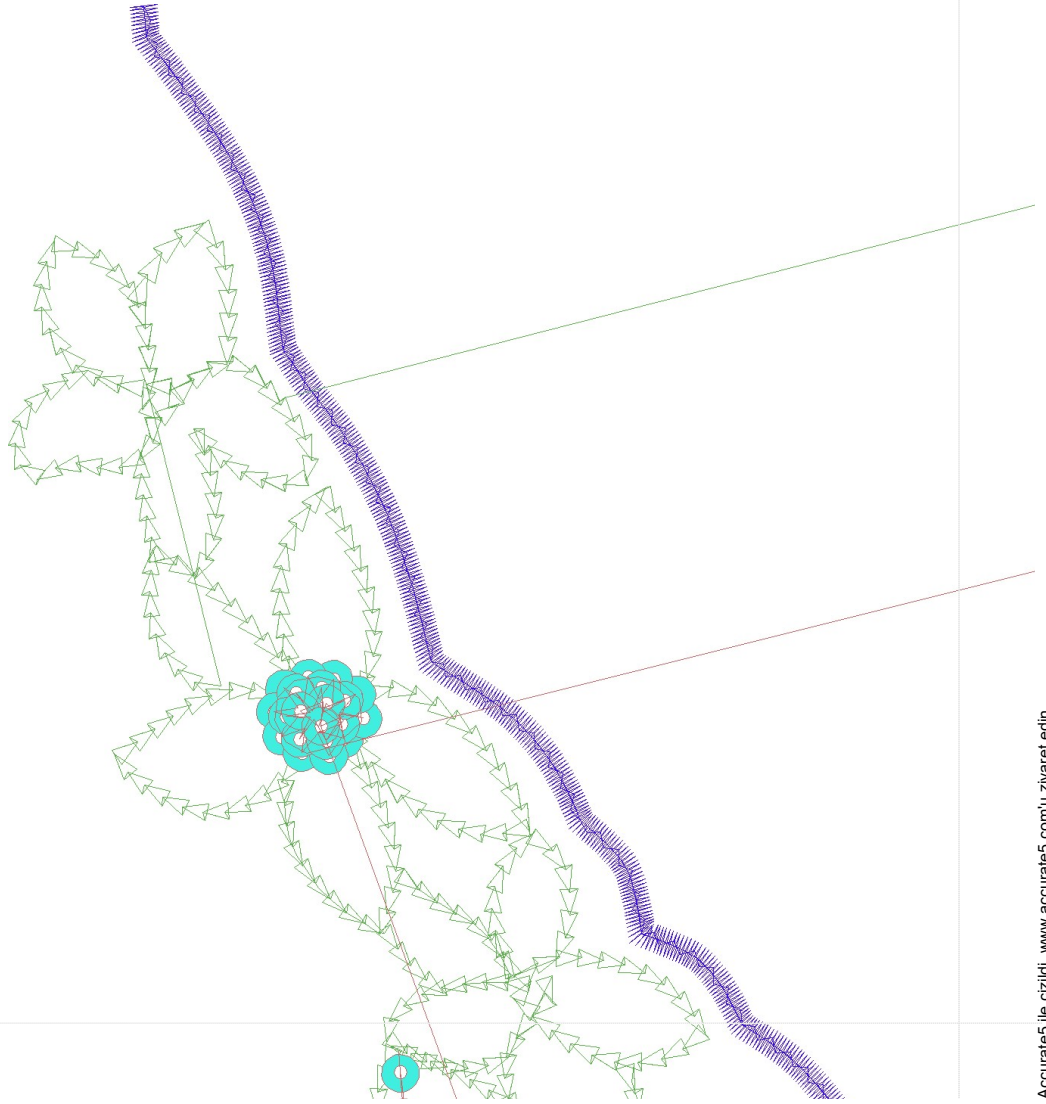

- #1 N1
- #2 S
- #3 N2
- #4 N3
- #4.PA ○○

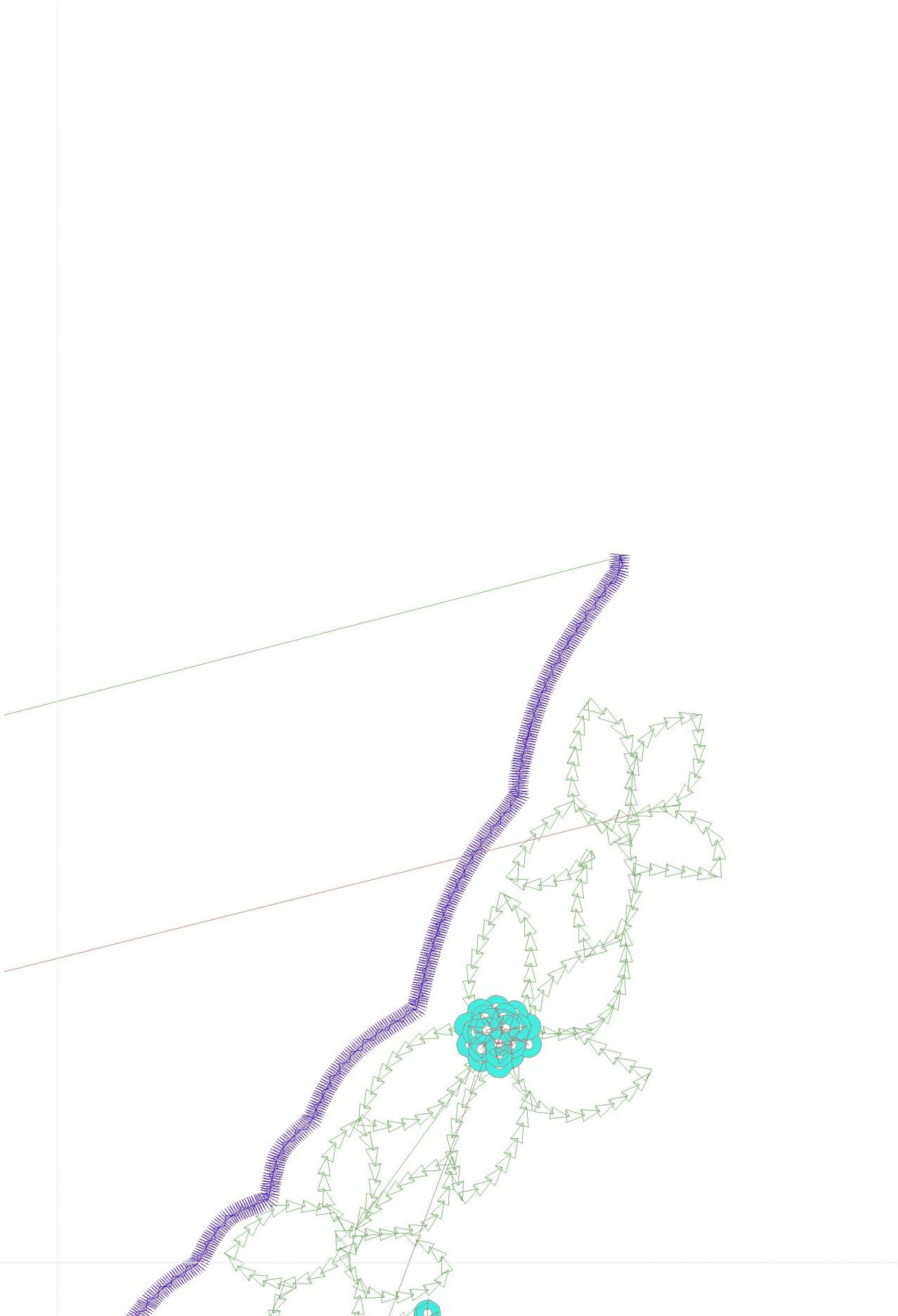

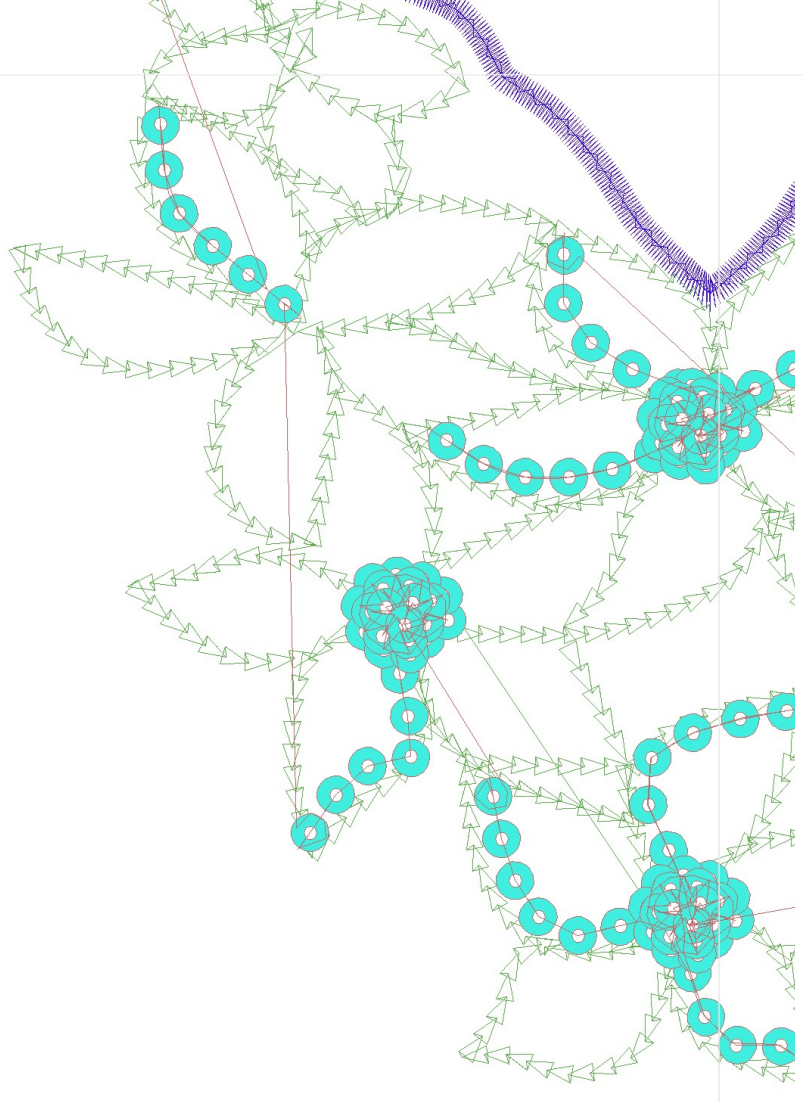



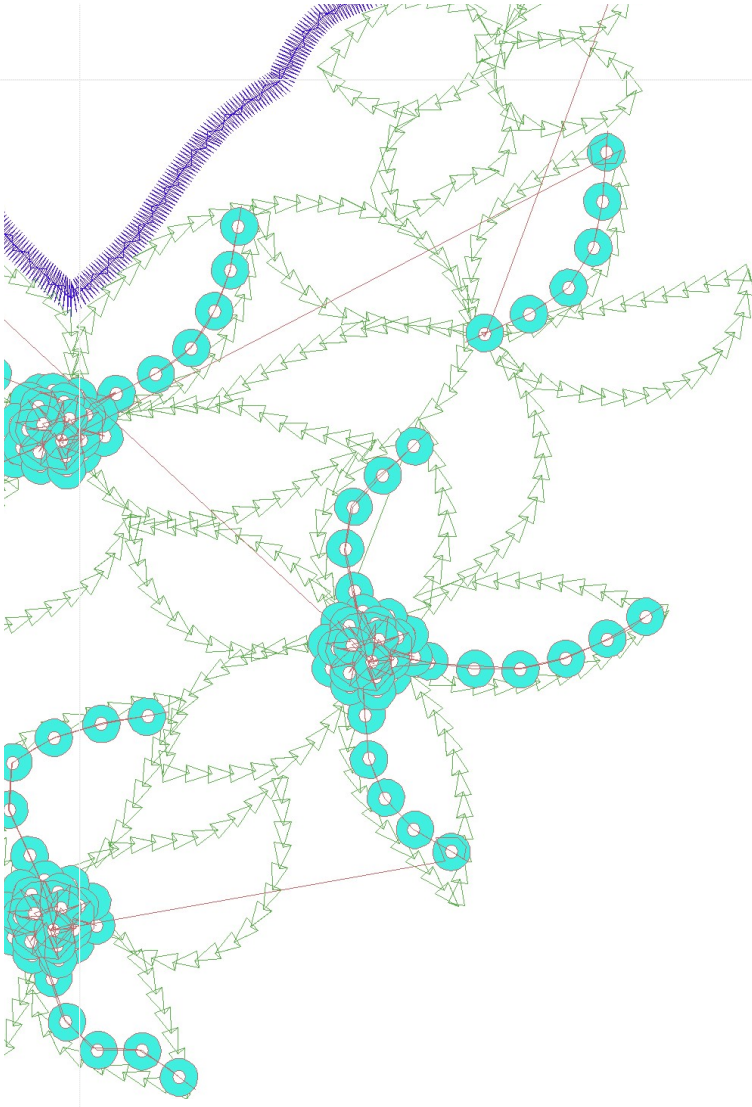



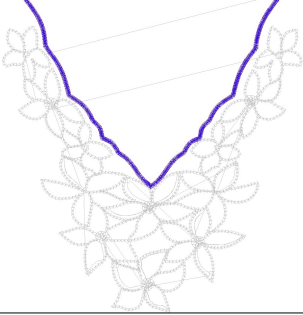
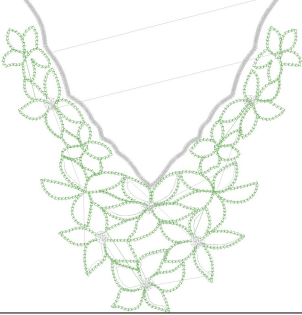
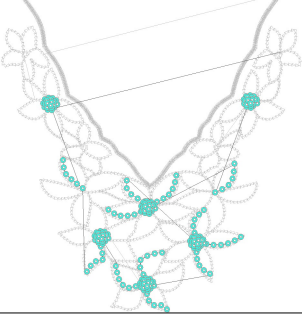

Desen no : 643.01  
Desen Adı : 38/40/42 BEDEN İMALAT  
Müşteri : MOTOR JEANS

Ölçek : 100 %  
Boyut : 251,4 x 269,4 mm  
Vuruş : 9964

		
#2 Fonksiyon:S İğne:1	#3 Fonksiyon:N2 İğne:2	#4.PA Fonksiyon:PA İğne:3

#2  S, İğne:1, Renk:Ackermann 3110  
#3  N2, İğne:2, Renk:Ackermann 5531  
#4.PA   PA, İğne:3, Renk:Ackermann 4430 / std-2 5,0 x 5,0

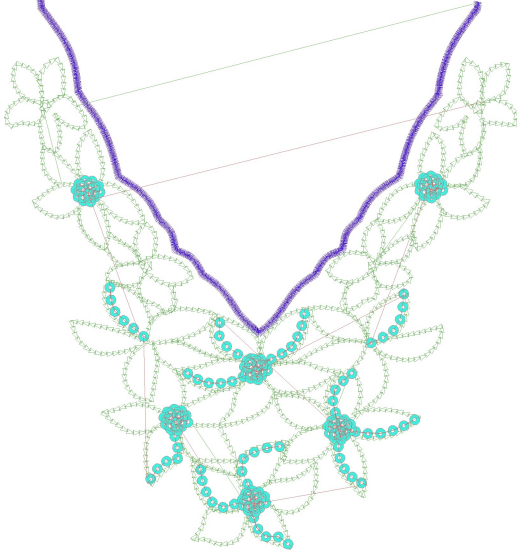

Desen no :643.01  
Desen Adı :38/40/42 BEDEN İMALAT  
Müşteri :  
Vuruş :9964  
Adım boyu :127  
Boyut :251,4 x 269,4 mm  
İğne :3  
Stop :1  
Çalışma sırası :1-s-2-3  
Açıklamalar :

## Vuruş Dağılımı

Aralık	Vuruş	Dağılım (Yüzde)
0,0 - 2,0 mm	1322	
2,0 - 4,0 mm	8281	
4,0 - 6,0 mm	88	
6,0 - 9,0 mm	7	

## İğneler\_Uzunluklar

Detay No	Fonksiyon	Vuruş	Uzunluk (m)	Renk	İğne Bilgisi
1	Nakişa Başla	2447	12,3		Ackermann 3110
2	İğne 2	5873	18,1		Ackermann 5531
3	İğne 3	1391	5,1		Ackermann 4430
4	Toplam uzunluk		35,5		
5	Alt iplik		24,5		

## Pul Sayıları

	A
3	188